

# Simply Torque MASTER KIT

by Sloky

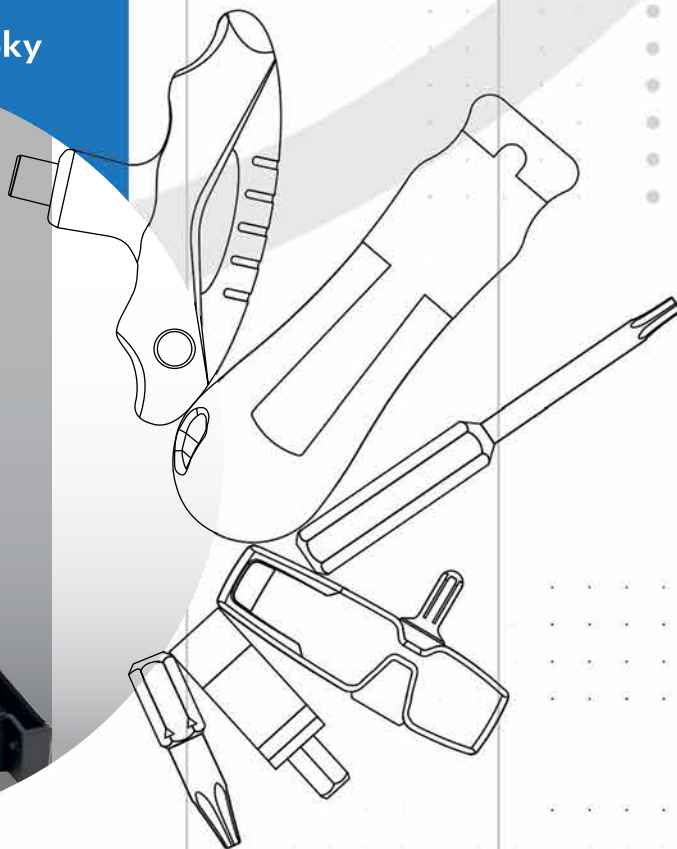

ZCC Cutting Tools Europe GmbH

your Partner | your Value

# Simply Torque

## - The Torque-Screwdriver-System

Simply Torque is based on the patented adapter “SLOKY®”.

It works as a “solo performer” with a unique feature to build a whole product system.

The torque's value is set on the adapter and when coupled with different bits and handles it becomes an unique torque screwdriver for tighten or loosen screws.

Simply Torque screwdriver, a predictable, replaceable and organised tool. It is designed to be used in industrial applications to avoid the “over tighten” of screws. It prevents damage to the screw and tool, in addition it enables bits with different shapes and dimensions to be used in the same handle.

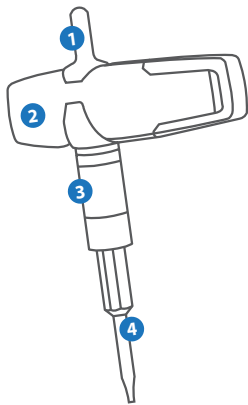

- ✓ 1. Fasten or loosen the screws quickly
- ✓ 2. Ergonomically refined design
- ✓ 3. Torque accuracy  $\pm 10\%$
- ✓ 4. Colour recognition



# Practicable

- When the torque setting is reached there is an audible 'click' to indicate that the correct torque pressure has been achieved.
- There is a reversible system in the unit to enable both tightening and loosening of screws.
- The torque limit for the loosening of screws is greater than tightening to protect both the tool and the screw head from damage.

*High efficiency  
High quality  
Product Highlight*

# Flexible

- The screw driver bit and the torque adapter are both replaceable.
- Light and precise! Ideal as an economic torque screwdriver.
- Simply Torque is the most compact torque screwdriver in the market.
- All components can be combined with each other.
- Very low costs compared to other systems.

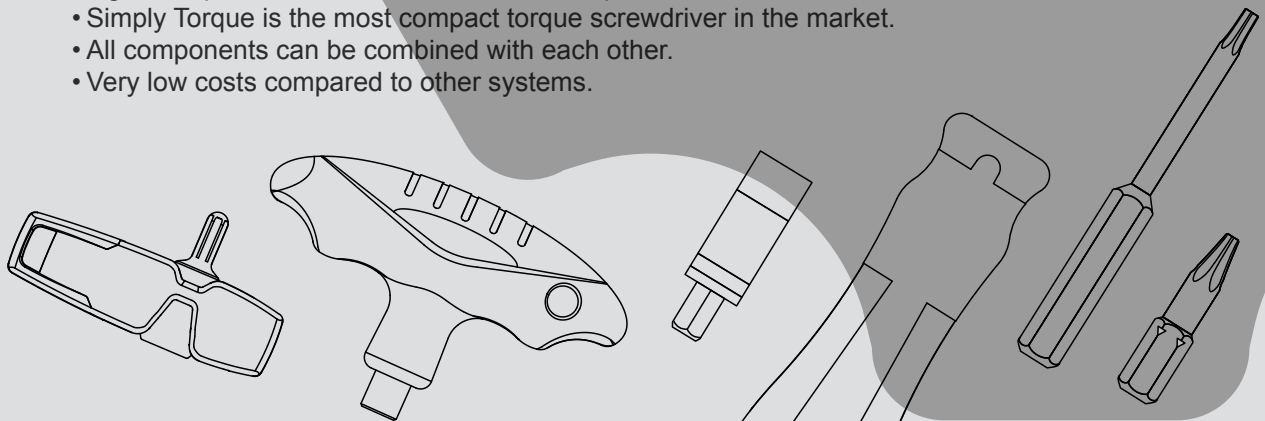

# Simply Torque

With the Simply Torque screw driver system you can safely change all the inserts in the ZCC Cutting Tools range. The screws can be fastened and loosened easily with reduced wear and tear. The ease and speed of operation also increases tool change productivity.



# Master Kit

## Torque Screwdriver for TORX® Master Kit 50mm Bits

Article No. (Set)	Content			Weight
	Type	Article No.	Pieces	
0-TPK17-MASTER-20K Master Kit	Handle	0-TPK-H01	1	698g
		0-TPK-H02	1	
		0-TPK-H02	1	
	Adapter	0-TPK-A06-0.6	1	
		0-TPK-A07-0.9	1	
		0-TPK-A08-1.2	1	
		0-TPK-A09-1.4	1	
		0-TPK-A10-2.0	1	
		0-TPK-A15-3.0	1	
		0-TPK-A20-5.0	1	
	Torx	0-TPK-B01-TX06-50	1	
		0-TPK-B01-TX07-50	1	
		0-TPK-B01-TX08-50	1	
		0-TPK-B01-TX09-50	1	
		0-TPK-B01-TX10-50	1	
		0-TPK-B01-TX15-50	1	
		0-TPK-B01-TX20-50	1	
		0-TPK-B01-TX25-50	1	
	Torx Plus	0-TPK-B02- 6IP-50	1	
		0-TPK-B02- 7IP-50	1	
		0-TPK-B02- 8IP-50	1	
		0-TPK-B02- 9IP-50	1	
		0-TPK-B02-10IP-50	1	
		0-TPK-B02-15IP-50	1	
		0-TPK-B02-20IP-50	1	
		0-TPK-B02-25IP-50	1	
	Hexagonal	0-TPK-B03-H02-50	1	
		0-TPK-B03-H02.5-50	1	
		0-TPK-B03-H04-50	1	
		0-TPK-B03-H04-50	1	



TORX® and TORX PLUS® are registered trademarks of Acument global technologies LLC.

**⚠ This product is only suitable for manual operation.**  
Do not apply with other electric tools or power tools.



## User Guide

### Tips for using different handles



Large support areas for thumb and index finger on the ergonomically shaped handles.

The transmission of high torques is thus quite simple. Cylindrical handle shaft for quick turning of screws.



The Slim Fit handle has been designed to fit snugly in your hand, making blisters and calluses a thing of the past, even after intensive use.

The handle hard zones allow the hand to glide easily during hand repositioning. The soft zones ensure full force transfer through the grip.



The T-Flying handle is needed whenever particularly high torque for loosening or tightening jobs needs to be applied.

The power is transferred positively, there is no frictional loss between the hand and the handle.

### Simple operation



The bits can be inserted in all adapters with magnetic and will be locked into the adapters automatically.

### Exchange bits system with colour coding

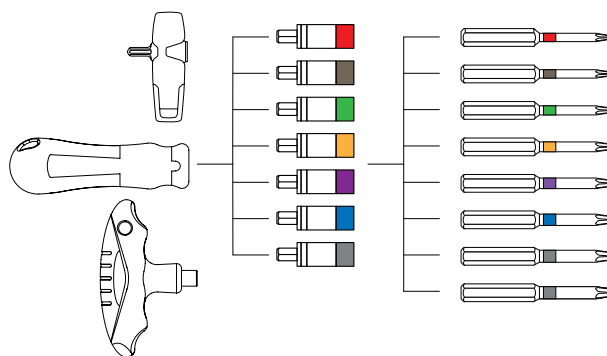

### Why the torque may be reduced after a period of use?

The torque adapter is operated by the radial direction friction, which is different to other competitors products. When an object slides past with another object relative friction is created on the two contact faces. This relative action is called the static friction, which leads to abrasion after sometime. That is why the predefined torque can decrease after intensive use.

### How to judge?

- +/-10% allowance for torque adapter is acceptable.
- Please check it on Torque analyser or measurement.



## A secure hold you'll never second-guess

A precision torque tool is only as good as its results. With proper testing equipment and system, we can ensure you never have to question our products accuracy and quality.

**SCHATZ® ANALYSIS** / The precise laboratory system  
Schatz AG of Germany torque testing equipment.



# Adapter

## Principle

The 'adapter' is designed to avoid over-tightening and has a non-return ratchet torque socket.

The adapter comprises a shaft rod and shaft outer cylinder. The outer cylinder is a movable ratchet which applies force to the screw until the correct present torque levels are reached. When the correct torque is reached there is an audible 'click' and any continued rotation of the screw driver handle does not apply any more tightening forces to the screw.

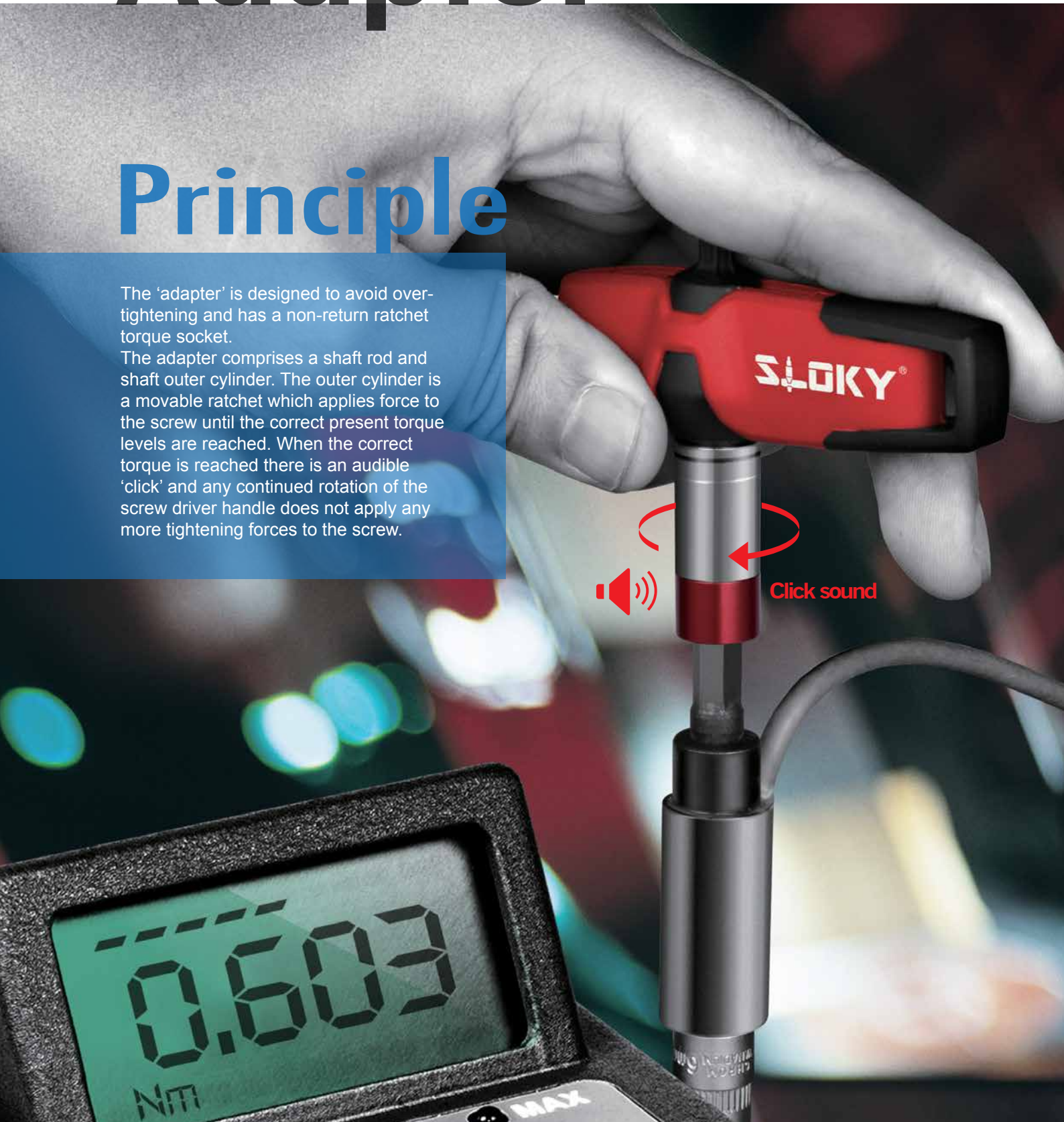

✓ 20,000 times product life test



used head of a screw  
without torque



used head of a screw  
with torque

Material : Carbon Steel

Hardness : HRC 43° ~ 48°

Surface Treatment : Electroless Nickel

Unit conversion : 1 Nm = 10.20kgf-cm

Installed with magnet

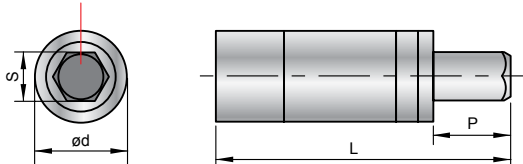

Article No.	Suitable	Ød (mm)	S (mm)	P (mm)	L (mm)	Nm	Kgfcmm	In-lb
0-TPK-A06-0.6	TX6 / 6IP	12	6.35	10	38.3	0.6	6.1	5.3
0-TPK-A07-0.9	TX7 / 7IP	12	6.35	10	38.3	0.9	9.2	8.0
0-TPK-A08-1.2	TX8 / 8IP H2	12	6.35	10	38.3	1.2	12.0	10.6
0-TPK-A09-1.4	TX9 / 9IP	12	6.35	10	38.3	1.4	14.0	12.4
0-TPK-A10-2.0	TX10 / 10IP H2.5	12	6.35	10	38.3	2.0	20.4	17.7
0-TPK-A15-3.0	TX15 / 15IP H3	12	6.35	10	38.3	3.0	30.6	26.6
0-TPK-A20-5.0	TX20 / 20IP	12	6.35	10	38.3	5.0	51.0	44.3

⚠ This product is only suitable for manual operation. Do not apply with other electric tools or power tools.





# Handle

## Features

Simply Torque offers **3** different types of handles.

There is a soft grip centre portion which is flexible and comfortable to hold. The handles are easy to use even in high torque applications. The ergonomic design of the handles ensures a perfect fit into the hand and thus avoids blisters and calluses during long and extended use.

✓ The ergonomic design of the handle





## Universal Handle

Features :

- Universal type for holding in multi-ways.
- Large support surfaces for thumb and index finger for high operator convenience.

Fig	Article No.	Suitable	Colour	S (mm)	L (mm)	H (mm)	Ø d (mm)	Weight
1	0-TPK-H01	0.6~5.5 Nm	Red	6.35	37.5	70.7	5	25g

## Slim-Fit Handle

Features :

- Slim fit for comfortable holding and accurate and efficient fastening and loosening of small sized screws.

Fig	Article No.	Suitable	Colour	S (mm)	L (mm)	Ø d (mm)	Weight
2	0-TPK-H02	0.6~2.0 Nm	Red	6.35	104	32.5	45g

## T Flying Handle

Features :

- Especially designed for higher torques.
- The striking soft zone allows particularly comfortable, handling.

Fig	Article No.	Suitable	Colour	S (mm)	L (mm)	H (mm)	Weight
3	0-TPK-H03	3.0~5.5 Nm	Red	6.35	65	100	59g

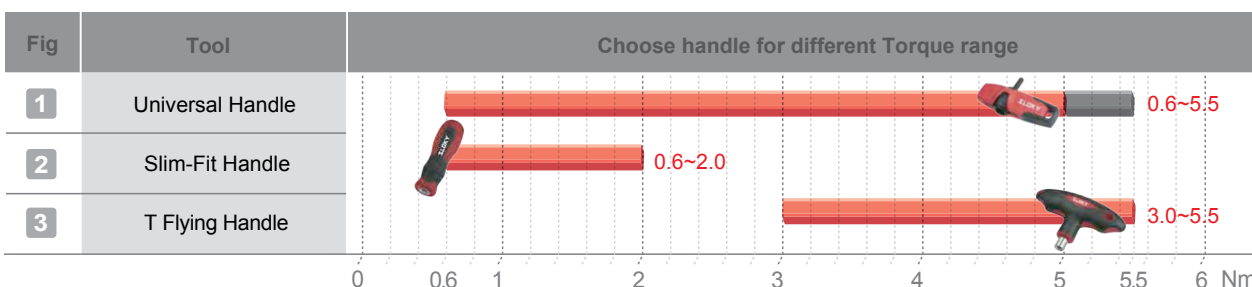

# Bits

## Colour recognition

No mistake!

The colour recognition coding is visible on both the adapter and the bits. Select the correct colour for the torque pressure required for the application. The colour recognition makes it easy to choose the right bit or torque adapter. That applies for all three system.



TORX®



TORX PLUS®



HEXAGONAL

TORX®

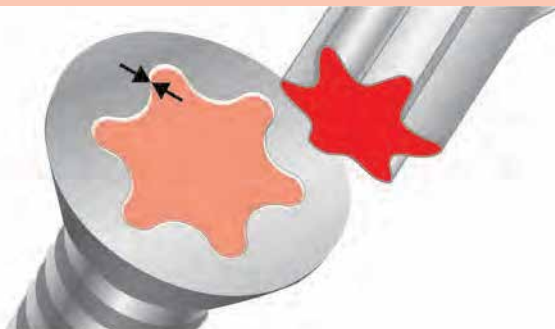

- TORX® drive between the tool and screw by line or surface contact rather than point contact.
- It also increases the amount of torque and force that can be transferred.

### 50mm Bits for TORX® screws

Hardness : HRC 58° ~60°

Material : High alloy steel

Standard : 1/4" DIN3126 – C6.3; DIN3126-E6.3

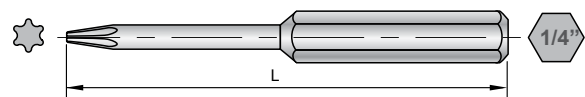

Article No.	Bit Size	L (mm)	Weight
0-TPK-B01-TX06-50	TX6	50	53 g
0-TPK-B01-TX07-50	TX7	50	53 g
0-TPK-B01-TX08-50	TX8	50	53 g
0-TPK-B01-TX09-50	TX9	50	55 g
0-TPK-B01-TX10-50	TX10	50	58 g
0-TPK-B01-TX15-50	TX15	50	59 g
0-TPK-B01-TX20-50	TX20	50	62 g
0-TPK-B01-TX25-50	TX25	50	62 g

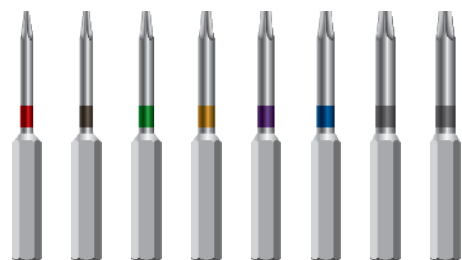

TORX® and TORX PLUS® are registered trademarks of Acument global technologies LLC.

## TORX PLUS®



- Larger contact surface between the tool and screw.
- The line of effective force is in the direction of movement (direction of rotation).

### 50mm Bits for TORX PLUS® screws

Hardness : HRC 58° ~60°

Material : High alloy steel

Standard : 1/4" DIN3126 – C6.3; DIN3126-E6.3

Article No.	Bit Size	L (mm)	Weight
0-TPK-B02- 6IP-50	6IP	50	53 g
0-TPK-B02- 7IP-50	7IP	50	53 g
0-TPK-B02- 8IP-50	8IP	50	53 g
0-TPK-B02- 9IP-50	9IP	50	55 g
0-TPK-B02-10IP-50	10IP	50	58 g
0-TPK-B02-15IP-50	15IP	50	59 g
0-TPK-B02-20IP-50	20IP	50	62 g
0-TPK-B02-25IP-50	25IP	50	62 g

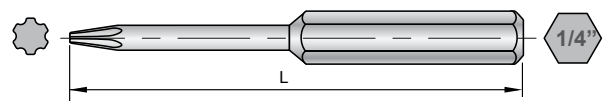

TORX® and TORX PLUS® are registered trademarks of Acument global technologies LLC.

## Hexagonal

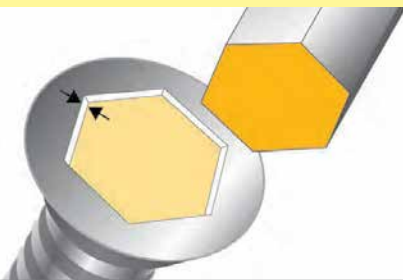

- External hexagon profile

### 50mm hexagonal bits

Hardness : HRC 58° ~60°

Material : High alloy steel

Standard : DIN3126 – E6.3 (1/4")

Article No.	Bit Size	H (mm)	G (mm)	I (mm)	L (mm)	Weight
0-TPK-B03-H02-50	H2	2	4	25	50	52 g
0-TPK-B03-H02.5-50	H2.5	2.5	4	25	50	55 g
0-TPK-B03-H04-50	H3	3	4.5	25	50	57 g
0-TPK-B03-H04-50	H4	4	6	25	50	61 g

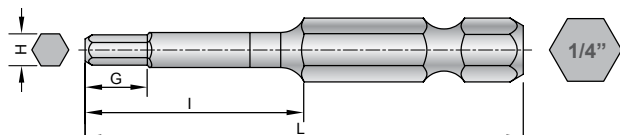



Sales center in Europe:

## **ZCC Cutting Tools Europe GmbH**

[www.zccct-europe.com](http://www.zccct-europe.com) [www.zccct.com](http://www.zccct.com)

Heltorfer Straße 12 40472 Düsseldorf, Germany

Tel.: +49(0)211-989240-0

Fax: +49(0)211-989240-111

E-mail: [Info@zccct-europe.com](mailto:Info@zccct-europe.com)

### **Distributor**

## **Trade Technology**

RUSSIA, Moscow, Ordzhonikidze str. 11 build 11

Tel.: +7(499)650-50-31

[www.zcc-ct.ru](http://www.zcc-ct.ru)

E-mail: [info@zcc-ct.ru](mailto:info@zcc-ct.ru)

